

Defender Series Installation Instructions

1 Remove case from holster (if applicable).

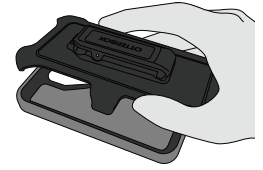

2 Peel away and remove the outer slipcover.

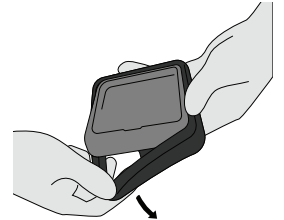

3 The shell separates into two pieces. To separate, find the arrows* on the shell back and release the corresponding snaps on the shell's side.

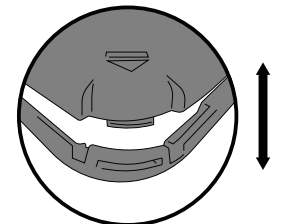
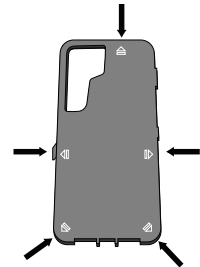

*Arrow locations may vary by device

4 Place the device into the bottom half of the shell.



5 Place the shell top half on the device and snap the two pieces together along all edges.

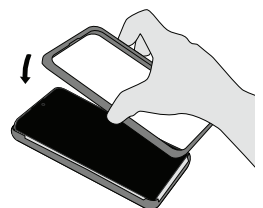

6

Wrap the slipcover around the shell. Ensure silicone slipcover is nested in groove and notches on all sides for a tight, secure fit.

