

# PURSUIT SERIES

## Install Guide for Apple

1. Hold the case face up and pull up on one side to release a section.

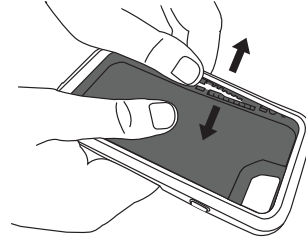

2. Pull apart around the edges and separate the lid from the base.

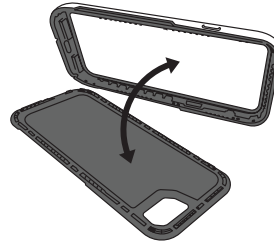

3. Place the device into the lid at an angle, leading with the mute switch side.

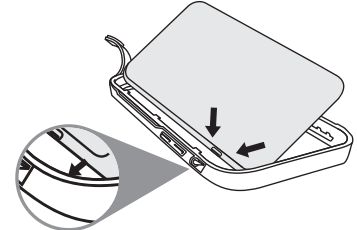

4. Place the base over the lid and snap together all the way around the edges.

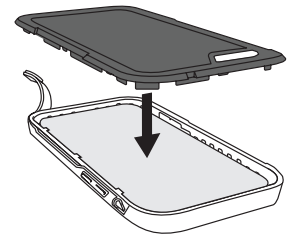

---

### Customer Service

1-855-688-7269 / USA + Canada - Toll Free

[support@otterbox.com](mailto:support@otterbox.com) / [otterbox.com/support](https://otterbox.com/support)



# GUIDE D'INSTALLATION

Du Boîtier Pursuit Series Pour Apple

1. Tenir le boîtier face vers le haut et tirer d'un côté pour libérer une section.

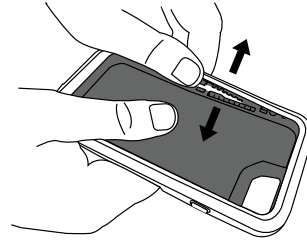

2. Tirer sur les bords et séparer le couvercle de la base.

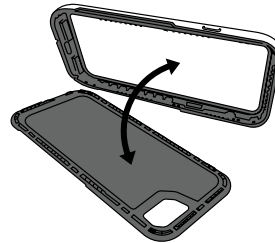

3. Placer l'appareil dans le couvercle en l'inclinant, en commençant par le côté du bouton sourdine.

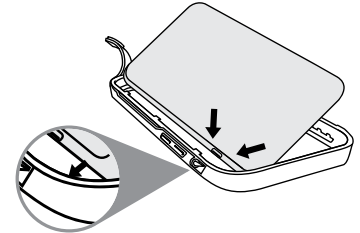

4. Placer la base sur le couvercle et encliquer tout le pourtour des bords.

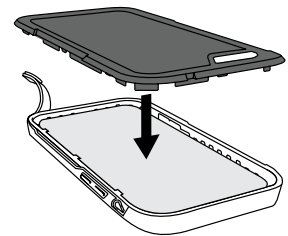

## Customer Service

1-855-688-7269 / USA + Canada - Toll Free  
[support@otterbox.com](mailto:support@otterbox.com) / [otterbox.com/support](https://otterbox.com/support)

**1-855-688-7269**

Service à la clientèle  
États-Unis et Canada : sans frais

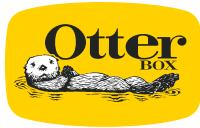

# GUÍA DE INSTALACIÓN

de Pursuit Series para Apple

1. Sostenga la caja boca arriba y jale de un lado para liberar una sección.

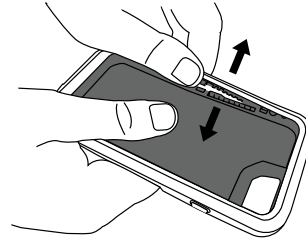

2. Separe los bordes y luego separe la tapa de la base.

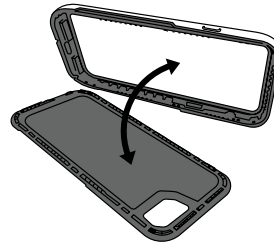

3. Coloque el dispositivo en la tapa en ángulo, empezando con el lado del interruptor de silencio.

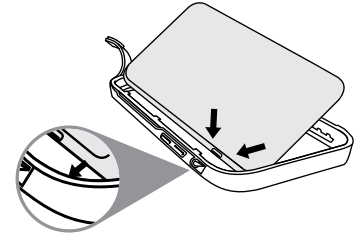

4. Coloque la base sobre la tapa y haga encajar todos los bordes.

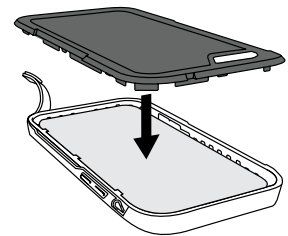

## Customer Service

1-855-688-7269 / USA + Canada - Toll Free

[support@otterbox.com](mailto:support@otterbox.com) / [otterbox.com/support](https://otterbox.com/support)



# PURSUIT SERIES

Einbauanleitung für Apple

1. Halten Sie die Hülle mit der Vorderseite nach oben und ziehen Sie eine Seite nach oben, um einen Bereich freizugeben.

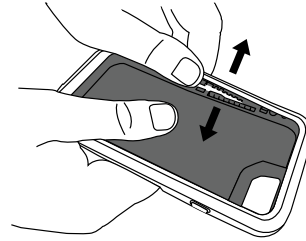

2. Ziehen Sie den Bereich an den Ecken entzwei und trennen Sie den Deckel von der Basis.

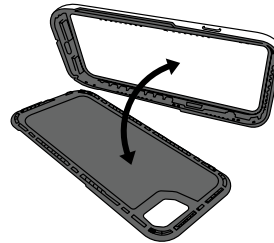

3. Legen Sie das Gerät angewinkelt in den Deckel und beginnen Sie dabei mit der Seite mit dem Stummschalter.

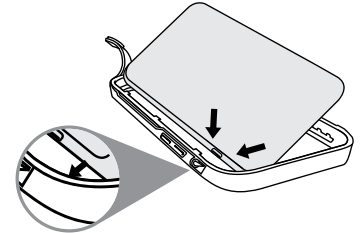

4. Legen Sie die Basis über den Deckel und lassen Sie sie überall an den Ecken einrasten.

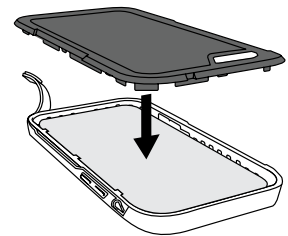

## Customer Service

1-855-688-7269 / USA + Canada - Toll Free

[support@otterbox.com](mailto:support@otterbox.com) / [otterbox.com/support](https://otterbox.com/support)



# GUIDE D'INSTALLATION

des produits Pursuit Series pour Apple

1. Maintenez le boîtier orienté vers le haut et tirez sur un côté pour dégager une section.

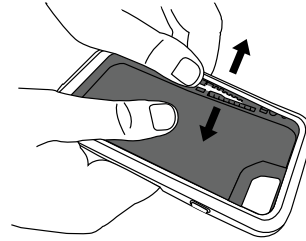

2. Tirez sur les bords et enlevez le couvercle de la base.

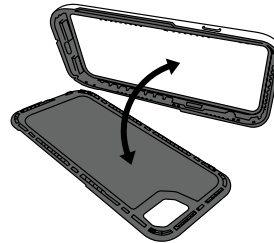

3. Placez l'appareil dans un coin du couvercle, du côté de la commande de la sourdine.

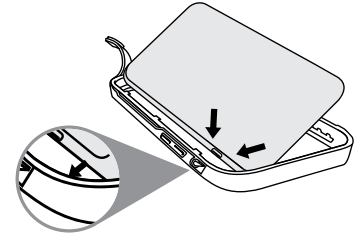

4. Positionnez la base sur le couvercle et fixez le tout par pression sur les bords.

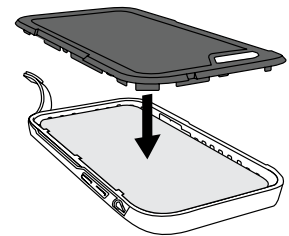

## Customer Service

1-855-688-7269 / USA + Canada - Toll Free  
[support@otterbox.com](mailto:support@otterbox.com) / [otterbox.com/support](https://otterbox.com/support)

**1-855-688-7269**

Service à la clientèle  
États-Unis et Canada : sans frais

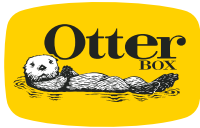

# GUIDA D'INSTALLAZIONE

di Pursuit Series per Apple

1. Con la cover rivolta verso l'alto, sollevare da un lato per sganciare una sezione.

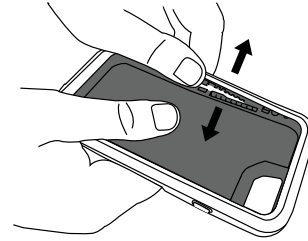

2. Tirare attorno agli angoli ed estrarre la custodia dalla base.

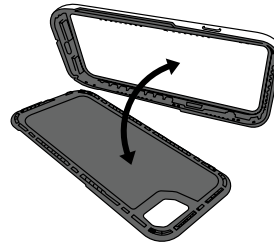

3. Inserire il dispositivo nella custodia tenendolo inclinato, iniziando con il lato in cui è presente il tasto silenzioso.

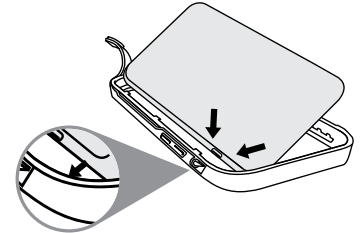

4. Inserire la base sulla custodia e chiudere a scatto su tutti gli angoli.

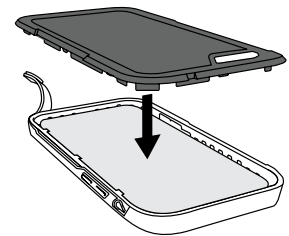

---

## Customer Service

1-855-688-7269 / USA + Canada - Toll Free

[support@otterbox.com](mailto:support@otterbox.com) / [otterbox.com/support](https://otterbox.com/support)

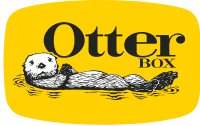

# PURSUIT SERIES

Installatiehandleiding voor de Apple

1. Houd de houder omhooggericht en trek aan één kant omhoog om een gedeelte vrij te maken.

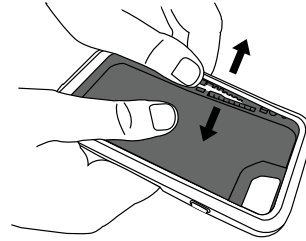

2. Trek het los langs de randen en scheid de deksel van de basis.

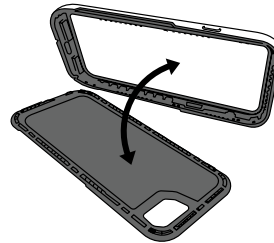

3. Plaats het apparaat in de deksel onder een schuine hoek, beginnend met de kant waar de mute-schakelaar zich bevindt.

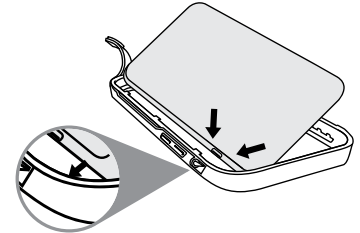

4. Plaats de basis over de deksel en klik ze samen. Ga daarbij helemaal rond de randen.

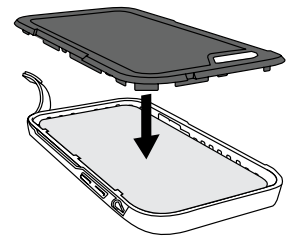

---

## Customer Service

1-855-688-7269 / USA + Canada - Toll Free

[support@otterbox.com](mailto:support@otterbox.com) / [otterbox.com/support](https://otterbox.com/support)



# GUÍA DE INSTALACIÓN

de Pursuit Series para Apple

1. Con la carcasa hacia arriba, tire de un lado para soltar una sección.

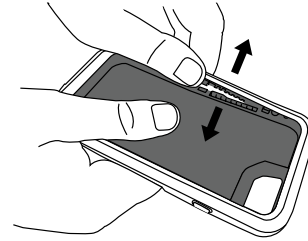

2. Tire de los costados y separe la tapa de la base.

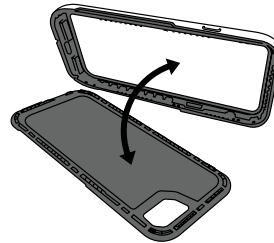

3. Coloque el dispositivo en la tapa con cierta inclinación y con el lado del botón de silencio primero.

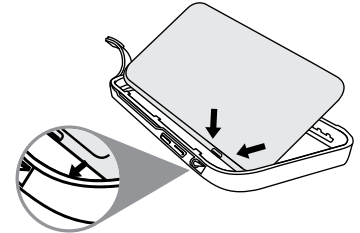

4. Coloque la base sobre la tapa y apriete bien por los costados para cerrarla.

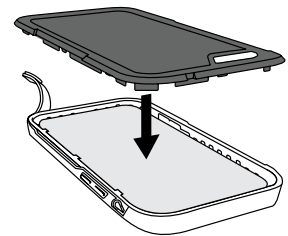

## Customer Service

1-855-688-7269 / USA + Canada - Toll Free

[support@otterbox.com](mailto:support@otterbox.com) / [otterbox.com/support](https://otterbox.com/support)



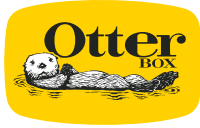

# GUIA DE INSTALAÇÃO

Pursuit Series para Apple

1. Segure a capa voltada para cima e levante de um dos lados para libertar uma parte.

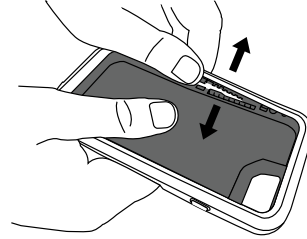

2. Afaste em toda a volta e separe a tampa da base.

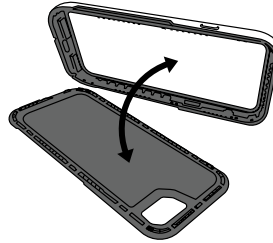

3. Coloque o dispositivo na tampa em ângulo, começando pelo lado do botão de desativar som.

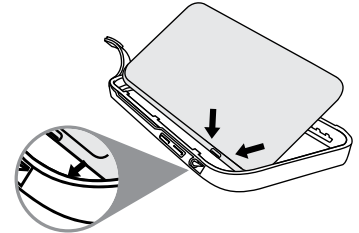

4. Coloque a base sobre a tampa e encaixe-a totalmente em toda a volta.

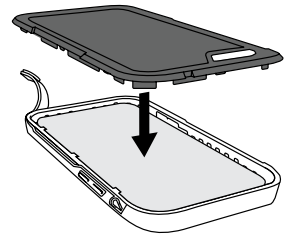

## Customer Service

1-855-688-7269 / USA + Canada - Toll Free

[support@otterbox.com](mailto:support@otterbox.com) / [otterbox.com/support](https://otterbox.com/support)



# INSTALLATIONSANVISNING

för Pursuit Series på Apple

1. Frigör en sektion genom att hålla lådans översida uppåt och dra uppåt i en sida.

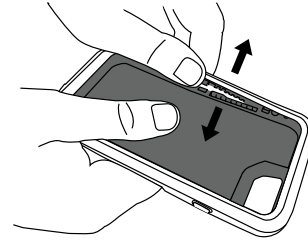

2. Dra isär kring kanterna och skilj locket från underdelen.

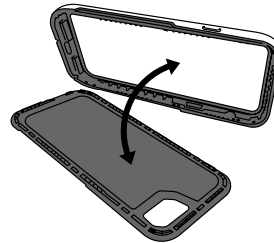

3. Placera enheten i locket med på knappen riktad framåt.

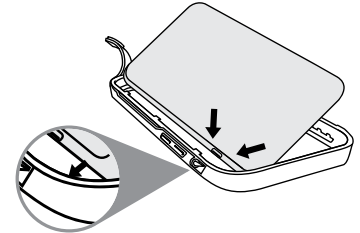

4. Placera underdelen över locket och snäpp ihop hela vägen kring kanterna.

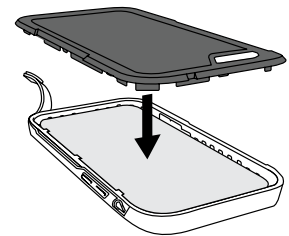

---

## Customer Service

1-855-688-7269 / USA + Canada - Toll Free

[support@otterbox.com](mailto:support@otterbox.com) / [otterbox.com/support](https://otterbox.com/support)



# РУКОВОДСТВО ПО УСТАНОВКЕ

## Pursuit Series для Apple

1. Держа крышку лицевой стороной вверх, потяните с одного края, чтобы отогнуть часть.

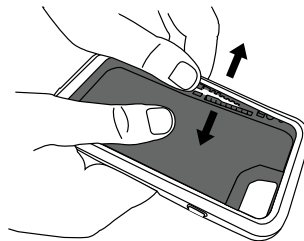

2. Потяните по краям, чтобы отделить крышку от основания.

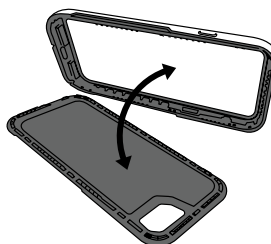

3. Поместите устройство в крышку под углом, начиная со стороны переключателей громкости.

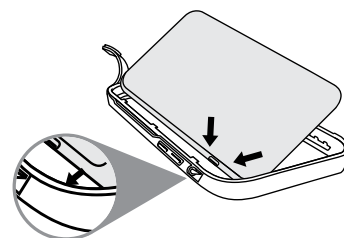

4. Наложите основание на крышку и защелкните по всем краям.

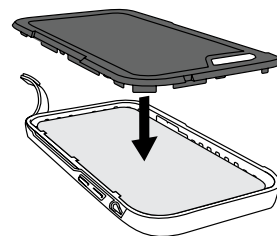

### Customer Service

1-855-688-7269 / USA + Canada - Toll Free

[support@otterbox.com](mailto:support@otterbox.com) / [otterbox.com/support](https://otterbox.com/support)



# PURSUIT SERIES –

instrukcja instalacji dla Apple

1. Przytrzymaj obudowę skierowaną ku górze i pociągnij z jednej strony, aby zwolnić sekcję.

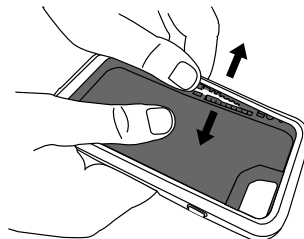

2. Oddziel pokrywę od podstawy, odczepiając ją dookoła krawędzi.

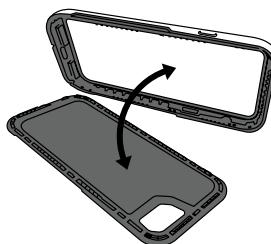

3. Umieść urządzenie w pokrywie pod kątem, wkładając najpierw stronę z przyciskiem wyciszania.

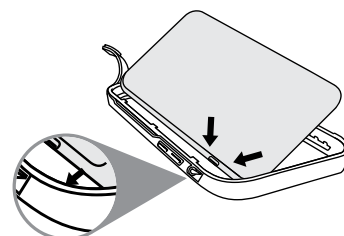

4. Umieść podstawę na pokrywie i zatrzaśnij ją dookoła wzdłuż krawędzi.

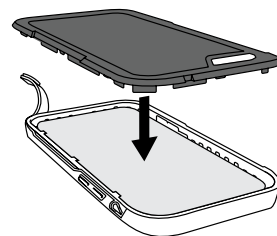

## Customer Service

1-855-688-7269 / USA + Canada - Toll Free

[support@otterbox.com](mailto:support@otterbox.com) / [otterbox.com/support](https://otterbox.com/support)



# PURSUIT SERIES

kotelon asennusopas Apple

1. Pidä koteloä etupuoli ylöspäin ja vedä toiselta puolelta ylös vapauttaaksesi osion.

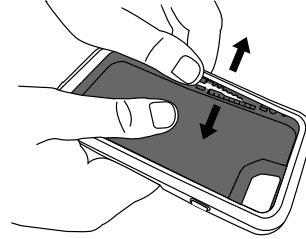

2. Vedä reunoista ulospäin ja irrota kansi pohjasta.

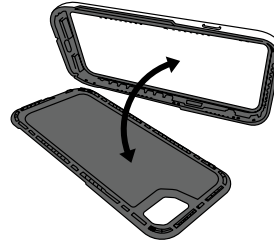

3. Aseta laite kanteen vinosti, vaimennuskytkimen puoli edellä.

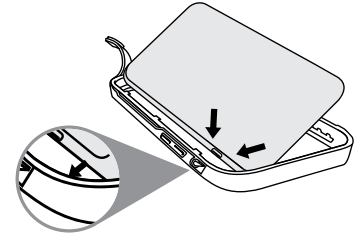

4. Aseta pohjaosa kannen päälle ja napsauta ne yhteen kaikista reunoista.

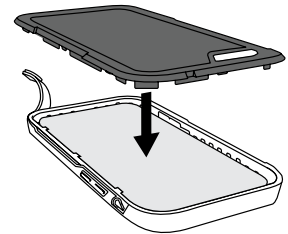

## Customer Service

1-855-688-7269 / USA + Canada - Toll Free

[support@otterbox.com](mailto:support@otterbox.com) / [otterbox.com/support](https://otterbox.com/support)



# APPLE İÇİN

## Pursuit Serisi Kurulum Kılavuzu

1. Kılıfı ön yüzü yukarı olacak şekilde tutun ve bir bölümü serbest bırakmak için bir taraftan yukarı doğru çekin.

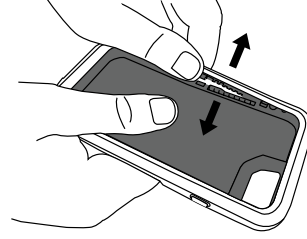

2. Kenarlardan çekerek kapağı tabandan ayırın.

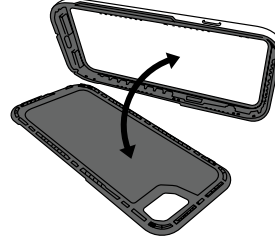

3. Aygıtı sessize alma tuşunun bulunduğu taraftan başlayarak kapağın içine belirli bir açıda yerleştirin.

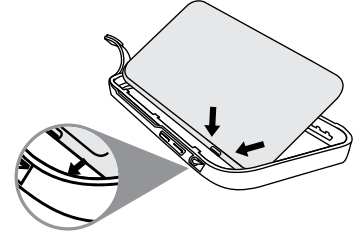

4. Tabanı kapağın üzerine yerleştirin ve kenarların tümünü yerine yerleştirin.

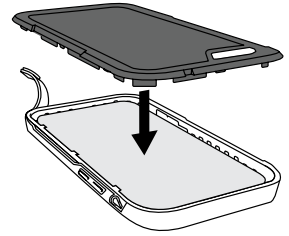

### Customer Service

1-855-688-7269 / USA + Canada - Toll Free

support@otterbox.com / otterbox.com/support



# دليل تركيب أمسك العلبة Apple Pursuit Series

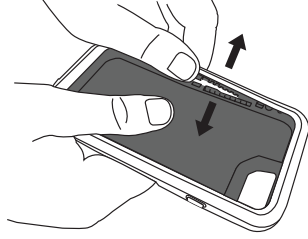

1. بحيث يكون وجهها لأعلى واسحب أحد الجانبين لأعلى  
لفصل أحد الأقسام

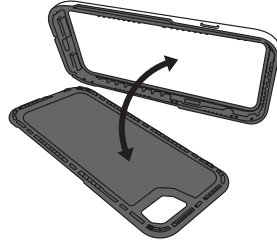

2. اسحب من الحواف بعيدًا وافصل الغطاء عن القاعدة

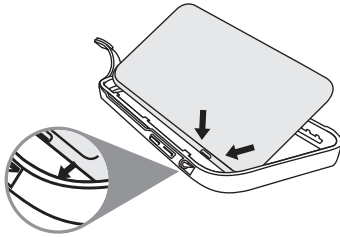

3. ضع الجهاز على الغطاء بزاوية، بحيث يكون الجانب الذي  
يتضمن مفتاح كتم الصوت في المقدمة

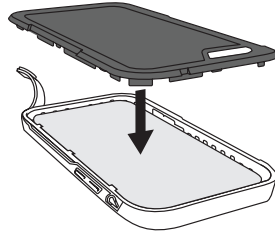

4. ضع القاعدة فوق الغطاء واضغط للتركيب على  
امتداد الحواف

## Customer Service

1-855-688-7269 / USA + Canada - Toll Free

support@otterbox.com / otterbox.com/support



# מדריך התקנת החזק את Apple עבור Pursuit Series

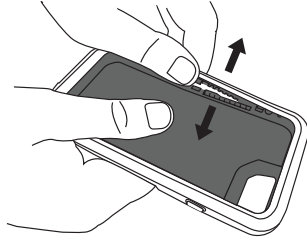

1. הכיסוי עם צד הפנים כלפי מעלה ומשוך כלפי מעלה בצד אחד כדי לשחרר חלק משוך והפרד לאורך הקצוות והפרד את

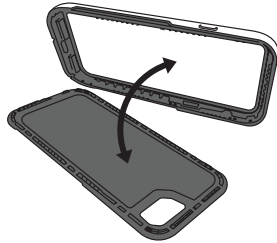

2. המכסה מהבסיס הכנס את המכשיר לתוך המכסה בזווית, כאשר

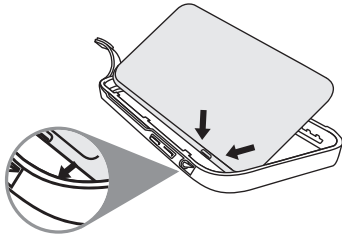

3. הצד של מתג ההשתקה נכנס ראשון מקום את הבסיס מעל המכסה וחבר אותו בנקישה

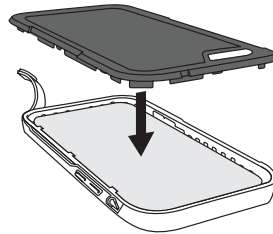

4. לכל אורך הקצוות

## Customer Service

1-855-688-7269 / USA + Canada - Toll Free

[support@otterbox.com](mailto:support@otterbox.com) / [otterbox.com/support](http://otterbox.com/support)





# APPLE用 Pursuit Series装着ガイド

1. ケースの表側を上にして持ち、片側を引っぱり、フタの一部を持ち上げます。

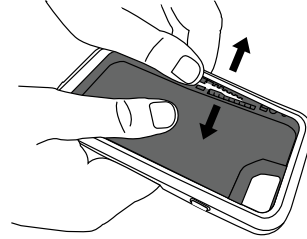

2. 縁に沿って引き上げていき、ベースからフタを取りはずします。

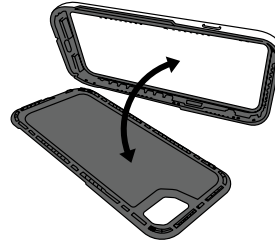

3. ミュートスイッチ側から、角度をつけてフタにデバイスを差し込みます。

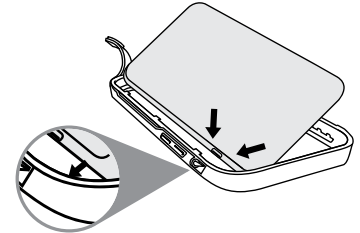

4. フタの上にベースを置き、縁に沿って全体をはめ込みます。

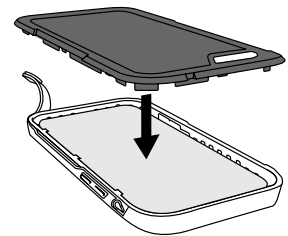

## Customer Service

1-855-688-7269 / USA + Canada - Toll Free

[support@otterbox.com](mailto:support@otterbox.com) / [otterbox.com/support](https://otterbox.com/support)

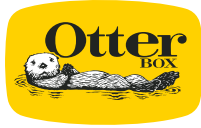

# APPLE용 Pursuit Series 장착 설명서

1. 케이스 앞면이 위를 향하도록 하고 한쪽을 위로 당겨서 벌립니다.

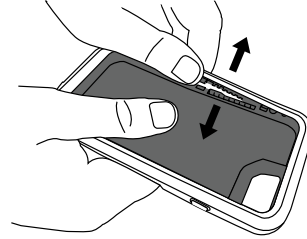

2. 가장자리를 따라 케이스를 당겨서 밀판에서 뚜껑을 분리합니다.

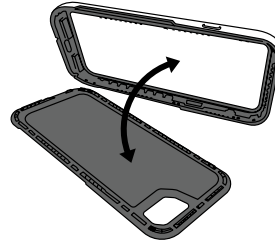

3. 장치를 음소거 스위치 쪽부터 뚜껑에 비스듬히 끼웁니다.

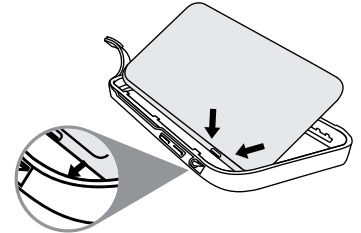

4. 밀판을 뚜껑 위에 올리고 가장자리를 따라 단단히 눌러 고정합니다.

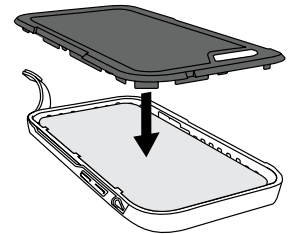

## Customer Service

1-855-688-7269 / USA + Canada - Toll Free

[support@otterbox.com](mailto:support@otterbox.com) / [otterbox.com/support](http://otterbox.com/support)

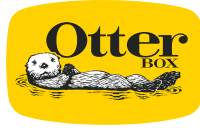

# PURSUIT SERIES

## 安裝指南 (Apple)

1. 手持保護殼面向上, 在一側往外拉, 使外殼與底蓋分離。

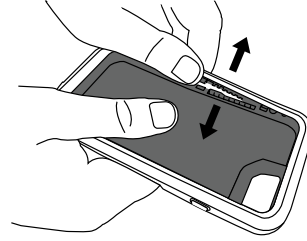

2. 沿著邊緣向外拉, 把整個外殼從底蓋拉出來。

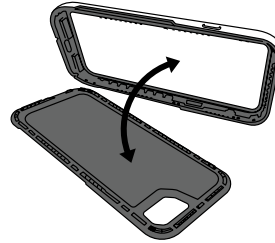

3. 把手機靜音鍵的一側對準外殼相應的位置, 斜向放進手機。

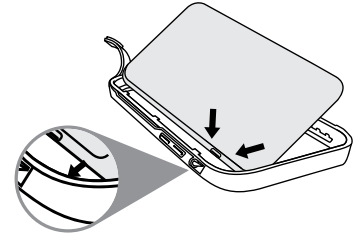

4. 把底蓋放回外殼上, 按壓邊緣以扣入到位。

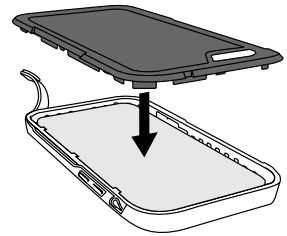

### Customer Service

1-855-688-7269 / USA + Canada - Toll Free

[support@otterbox.com](mailto:support@otterbox.com) / [otterbox.com/support](https://otterbox.com/support)

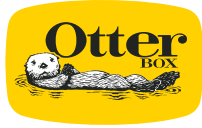

# 适用于 APPLE 的 Pursuit Series 安装指南

1. 手持外壳正面朝上, 拉开一侧, 以松开一角。

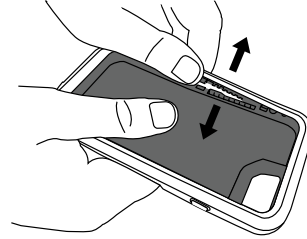

2. 沿周边拉开, 使底座与盖子分离。

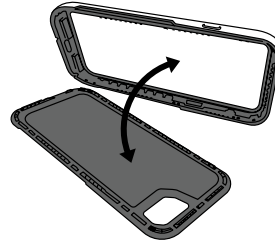

3. 将装置斜着放入盖内, 首先从有静音开关那一侧开始。

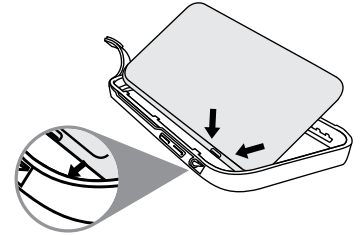

4. 将底座置于盖上, 沿周边卡紧。

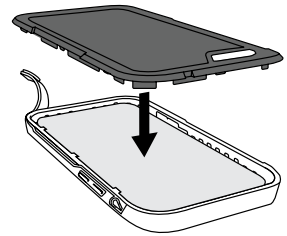

## Customer Service

1-855-688-7269 / USA + Canada - Toll Free

[support@otterbox.com](mailto:support@otterbox.com) / [otterbox.com/support](http://otterbox.com/support)