

OtterBox Symmetry Series Flex case for Galaxy Z Fold4

1

NOTE: If case has separated, thread hinge between the two plastic pieces by sliding it back and forth until hinge is firmly in place.

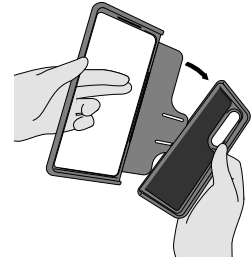

2

There are six pieces of adhesive to help the case attach to the device.

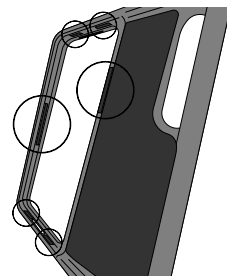
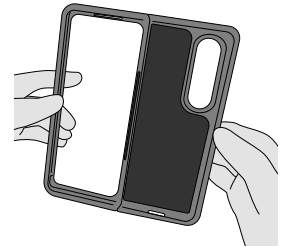

3

Grab the small tabs to pull the film off the case. A quick tip is to use a pair of tweezers to grab the tabs.

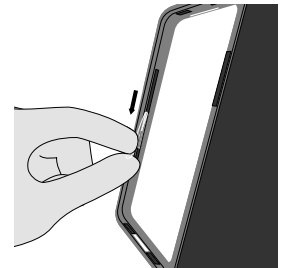

4

Once adhesive films are removed, lay case on a stable, flat surface and press down on case. You might notice a little bit of a bend to the plastic — that's perfectly normal.



5

Align camera and buttons with case openings and place phone in case.

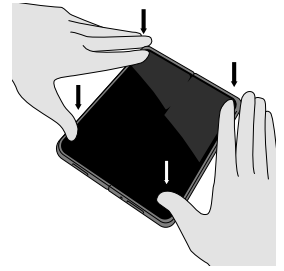

6

Press around edges, sides and back to secure phone inside case.

